



4 Fairview

Offers Over £175,000

🛏 3 🍳 2 🛋 2



- Terraced Family Home
- Modern Build - 15 Year Old
- Three/Four Bedrooms
- First Floor Home Office
- Family Bathroom & Ensuite Shower Room
- Generous Front Aspect Living Room
- Full Width Kitchen/Diner
- Enclosed Courtyard Garden & Parking
- Downstairs WC
- Great Decorative Order Throughout



Offering generous proportions throughout, this modern terraced home provides fantastic ground floor accommodation that includes a spacious bay-fronted living room as well as a full width kitchen/diner that opens via double doors to your own enclosed courtyard garden with rear gates that allows off street parking. The first floor is currently arranged as a three bedroom house with home office, but could easily be used a four bedroom property if your circumstance required it. All bedrooms are supported by a three-piece family bathroom plus ensuite off the master bedroom. This home is offered to market in great decorative order and has the added benefit of a downstairs WC off the entrance lobby. We encourage an internal viewing inspection to confirm if this has the potential to be your next home.

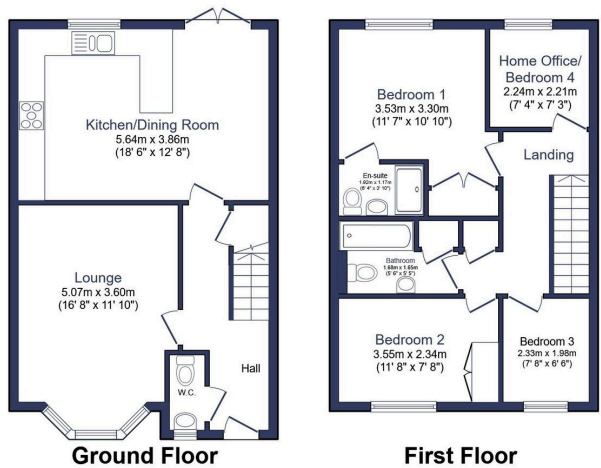

Total floor area 97.2 m² (1,046 sq.ft.) approx

This floor plan is for illustrative purposes only. It is not drawn to scale. Any measurements, floor areas (including any total floor area), openings and orientation are approximate. No details are guaranteed, they cannot be relied upon for any purpose and they do not form part of any agreement. No liability is taken for any error, omission or misstatement. A party must rely upon its own inspection(s). Powered by www.focalagent.com

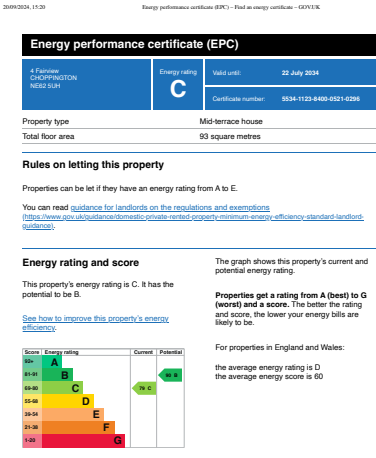

<https://find-energy-certificate.service.gov.uk/energy-certificate/5536-1122-8400-0521-0296?print=true>

1/4